

ZG1200 VOYAGER PASSENGER ARMREST K53002-044 , K53002-047 A

QTY	P/N	DESCRIPTION
2	440581	ARMREST RETURN SPRING
2	303223	1/4 - 20 x 2 3/4" CARRIAGE BOLT, CHROME
2	302319	1/4 - 20 HEX HALF NYLOCK NUT, PLATED
4	301702	1/4 x .060" WHITE NYLON WASHER
6	301131	1/4" SAE FLAT WASHER, PLATED
12	302512	#10-32 KEPS NUT, PLATED
12	301217	#10 FENDER WASHER, PLATED
4	303170	1/4 - 20 x 3/4" HEX HEAD BOLT, PLATED
8	770071	16 mm SNAP CAP, CHROME
8	770076	16 mm SNAP CAP WASHER
8	304718	#10-32 x 1/2" PHILLIPS PAN HEAD SCREW, PLATED
4	304166	#10-32 x 5/8" PHILLIPS PAN HEAD SCREW, PLATED
2	740303	ARMREST PAD, BURGUNDY
2	740337	ARMREST PAD, BLACK
2	740349	ARMREST PAD, BLACK '94
2	940266	ARMREST SUPPORT STOP WELDMENT ASSEMBLY
1	440510	RIGHT ARMREST MOUNT PLATE
1	440515	LEFT ARMREST MOUNT PLATE
1	640505	RIGHT ARMREST SUPPORT WELDMENT
1	640510	LEFT ARMREST SUPPORT WELDMENT

NOTE: PLEASE READ ALL INSTRUCTIONS BEFORE STARTING INSTALLATION.

1. PLACE YOUR MOTORCYCLE ON ITS CENTERSTAND.
2. REMOVE ALL ARTICLES FROM INSIDE THE TRAVEL TRUNK, THEY COULD BE DAMAGED WHEN DRILLING THE TRUNK.
3. START WITH THE LEFT SIDE AND PUT 2" WIDE MASKING TAPE ON THE TRUNK AS SHOWN (FIG. 1). HOLD THE LEFT ARMREST MOUNT PLATE (440515) UP ONTO THE TRUNK AND SLIDE IT UP UNTIL IT HITS THE LIP WHERE THE LID & BOTTOM COME TOGETHER.

NOTE: THE SIDE OF THE MOUNT PLATE WITH FOUR (4) HOLES FACES FORWARD AND THE TWO (2) CENTER HOLES ARE TOWARDS THE BOTTOM (FIG. 1)

4. MARK THE HOLE CENTERS WITH A PENCIL, BE SURE PART IS PLACED CORRECTLY AS SHOWN IN (FIG. 1) AND DOES NOT MOVE WHEN MARKING THE HOLES.
5. REMOVE THE MOUNT PLATE AND CAREFULLY DRILL A 7/32" HOLE THROUGH EACH OF THE SPOTS MARKED.
6. REMOVE THE MASKING TAPE AND LIGHTLY DEBURB EACH OF THE HOLES INSIDE & OUT.

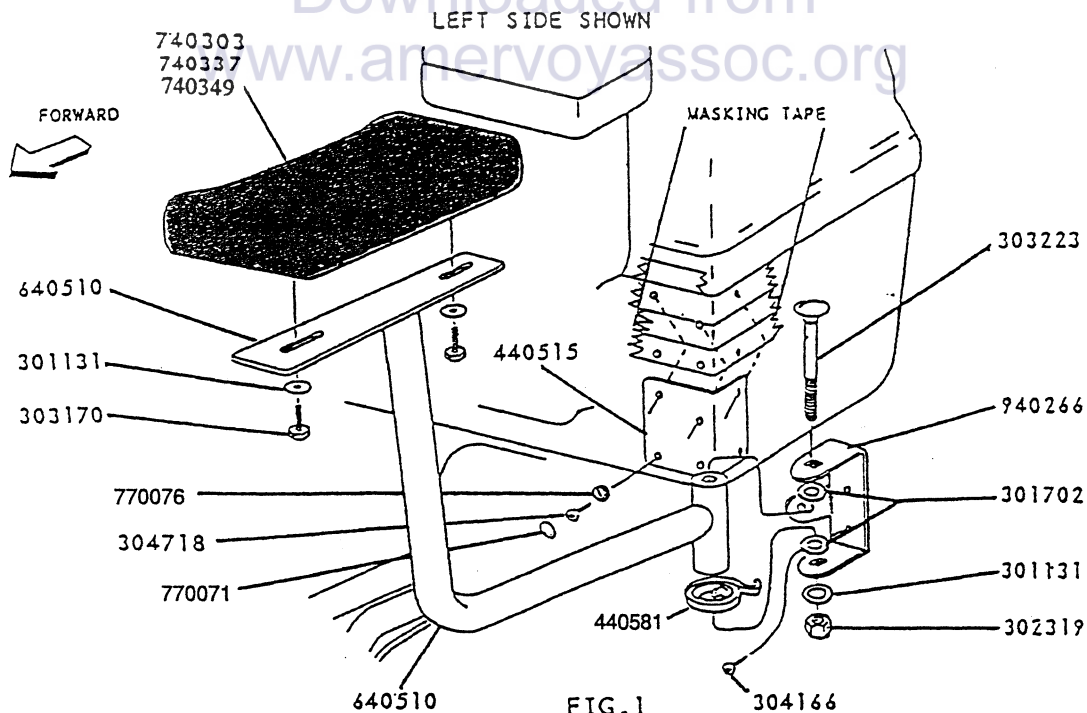

ZG1200 VOYAGER PASSENGER ARMREST K53002-044 , K53002-047 A

7. USING THE #10-32 x 5/8" SCREWS MOUNT THE LEFT ARMREST SUPPORT STOP WELDMENT ASSEMBLY (940266), WITH THE STOP TAB ON THE INSIDE, AND THE LEFT ARMREST MOUNT PLATE TO THE TRUNK, AS SHOWN. LEAVE IT LOOSE FOR NOW. USE THE 2 MIDDLE HOLES.

NOTE: #10 FENDER WASHER (301217) FITS UNDERNEATH 10-32 KEPS NUT (302510) INSIDE TRUNK.

8. PUT THE 13mm SNAP CAP WASHER OVER THE #10-32 x 1/2" SCREWS AND FINISH INSTALLING THE MOUNT PLATE THROUGH THE 4 CORNER HOLES AS SHOWN. TIGHTEN THE 4 SCREWS AND INSTALL CHROME SNAP CAPS OVER THE SCREWS.
9. THE SUPPORT STOP WELDMENT WITH RUBBER BUMPER SHOULD BE LINED UP AS VERTICALLY AS POSSIBLE AND THEN TIGHTENED UP.
10. REFER TO (FIG. 2) FOR PROPER SPRING INSTALLATION & PRELOADING.
11. THE SPRINGS ARE THE SAME FOR LEFT OR RIGHT ONLY REVERSED IN ORDER TO APPLY PRESSURE TO ROTATE THE SUPPORT ARMS BACK TO THE STOP.
12. INSERT THE 1/4-20 x 2 3/4" CARRIAGE BOLT THROUGH THE TOP SQUARE HOLE IN THE SUPPORT STOP WELDMENT JUST ENOUGH TO PUT THE 1/4" WHITE NYLON WASHER ON IT. NOW INSTALL THE SPRING ONTO THE SLOT IN THE SUPPORT ARM (THE SLOT FACES TOWARD THE CENTER OF THE CYCLE).

NOTE: PUT SOME MASKING TAPE ON THE OUTSIDE FRONT EDGE OF TRUNK LID TO PREVENT CARRIAGE BOLT FROM SCRATCHING IT.

13. SLIDE THE SUPPORT ARM UP ONTO THE CARRIAGE BOLT AT AN ANGLE AND HOOK THE END OF THE SPRING OVER THE OUTSIDE EDGE OF THE SUPPORT STOP WELDMENT AS SHOWN.
14. PUSH THE BUSHING INTO THE MIDDLE OF THE SUPPORT ARM STOP WELDMENT AND INSTALL THE LOWER 1/4" NYLON WASHER. PUSH THE CARRIAGE BOLT ON THROUGH BOTTOM BRACKET.
15. INSTALL 1/4" FLAT WASHER & 1/4-20 HEX HALF NYLOCK NUT. DO NOT OVER TIGHTEN THE 1/4-20 HEX HALF NYLOCK NUT OR THE ARMREST WILL NOT PIVOT FREELY AND SPRING BACK.
16. IF THE ARMRESTS DO NOT ROTATE BACK TO THE STOPS, THE 1/4-20 NUTS ARE PROBABLY A LITTLE TOO TIGHT, OR THE SPRING IS NOT PRELOADED PROPERLY.
17. INSTALL THE ARMREST PADS ON THE TOP BRACKET OF EACH SUPPORT USING THE 1/4-20 x 3/4" BOLTS & WASHER PROVIDED (FIG. 1). THE CURVED SIDE OF THE PAD SHOULD FACE INWARD ON EACH SIDE. TIGHTEN THESE FOUR BOLTS SECURELY.

18. REPEAT STEPS 3 THROUGH 17 FOR THE RIGHT AND INSTALLATION IS NOW COMPLETE.

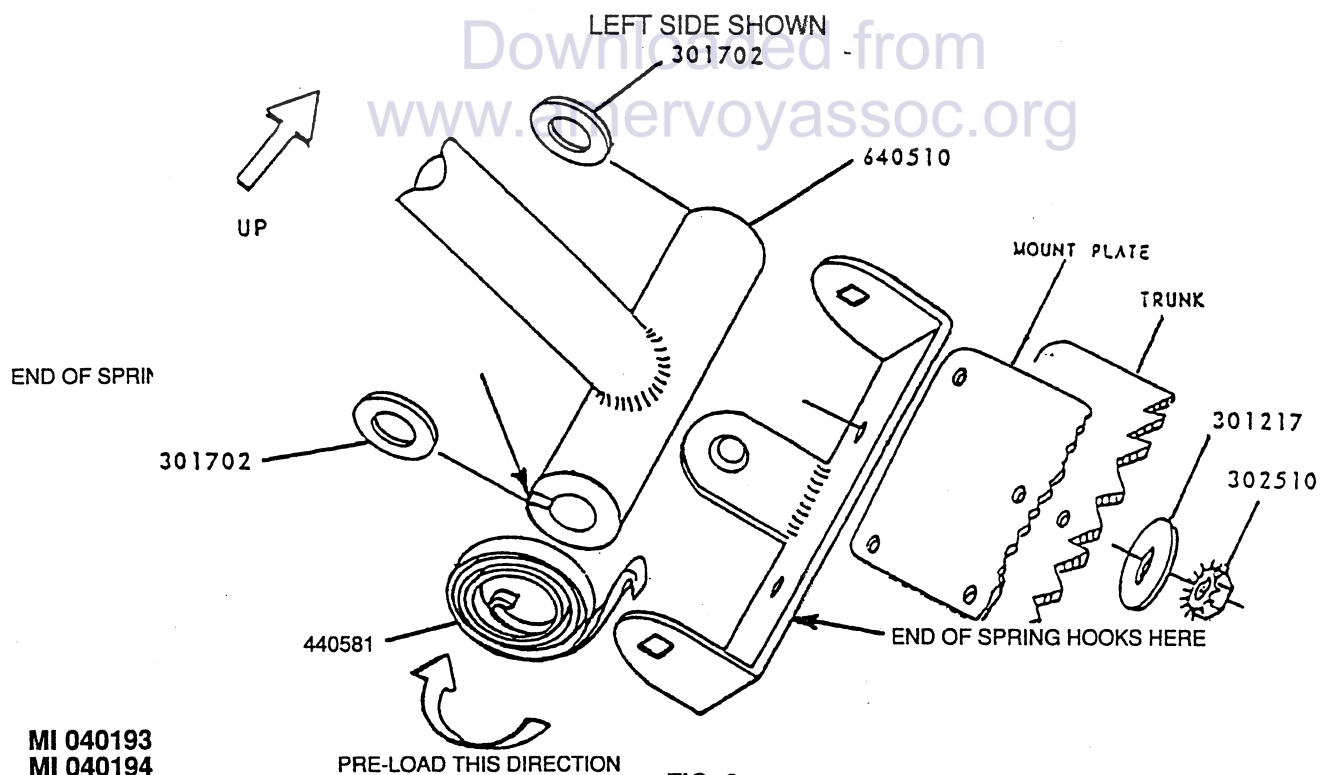

FIG. 2